

# Cimarron

## LED

**NEW!**  
Over 26,000 Lumens!



## SPAULDING LIGHTING

UNIQUE VERTICAL HEAT SINK FINS (ELIMINATE ACCUMULATION OF DEBRIS)

HIGHLY EFFICIENT LED TECHNOLOGY (77-98 LPW)

PART OF THE SOUTHWEST FAMILY OF OUTDOOR FIXTURES

MULTIPLE LUMEN PACKAGES & LIGHTING DISTRIBUTIONS

LONG LIFE - 60,000 HOURS

STANDARD CCT - 4000K & 5000K

CONTROL READY

THERMAL PROTECTION

MADE IN THE U.S.A.

5 YEAR WARRANTY

DARK SKY APPROVED



DESIGNLIGHTS  
CONSORTIUM



[www.spauldinglighting.com](http://www.spauldinglighting.com)

**NEW!**  
Over 26,000 Lumens!

**SPAULDING  
LIGHTING**

**Cimarron LED**

# Maximum Performance Superior Value



Mast Arm Fitter

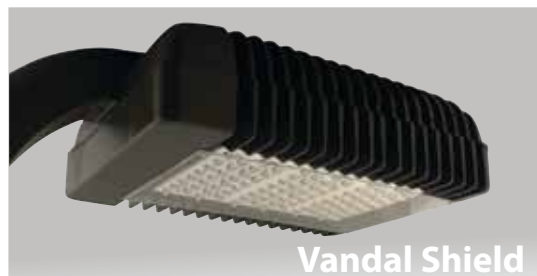
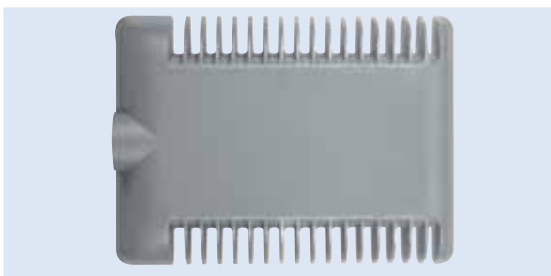

Vandal Shield

The new Cimarron LED features a solid die-cast housing assembly which maintains the same architectural profile as its predecessor. The Cimarron LED housing features unique vertical fins along the side walls to dissipate heat as well as channel rain water away from the top housing, keeping the fixture cool and clean for years. For versatility the Cimarron LED uses the same #2 drill pattern so it can be easily retrofitted to existing Cimarron installations. It can also be mounted to poles or arms with the optional mast arm fitter. For extra protection, a vandal shield option is available. The luminaire also features ECLIPSE Backlight Control, this unique system, designed specifically for LED lighting, will reduce the light spill behind the pole by approximately 85% when installations are close to the street or the neighbor's property line, providing a neighbor-friendly lighting solution.

Available in multiple lumen output packages with IES type II, III, IV and V distributions:

- 90 LEDs at 310w, producing over 26,000 lumens
- 90 LEDs at 210w, producing 20,000 lumens
- 60 LEDs at 140w, producing 13,000 lumens
- 30 LEDs at 70w, producing 7,000 lumens



For more information  
on the Cimarron LED  
use your smart phone  
to scan this code

